

| MULTI-RIB material | |
|--------------------|--------------------|
| 0.55mm | Colorsteel® Endura |
| 0.55mm | Colorsteel® Maxx |
| 0.55mm | Zincalume |

Step roofing flashing to match MULTI-RIB material

Freeman Group Ltd MULTI-RIB Long Run Roofing

Foam

Freeman Group Ltd MULTI-RIB Long Run Roofing

Vapour barrier/ Roofing Underlay to underside cladding

Cold rolled purlins

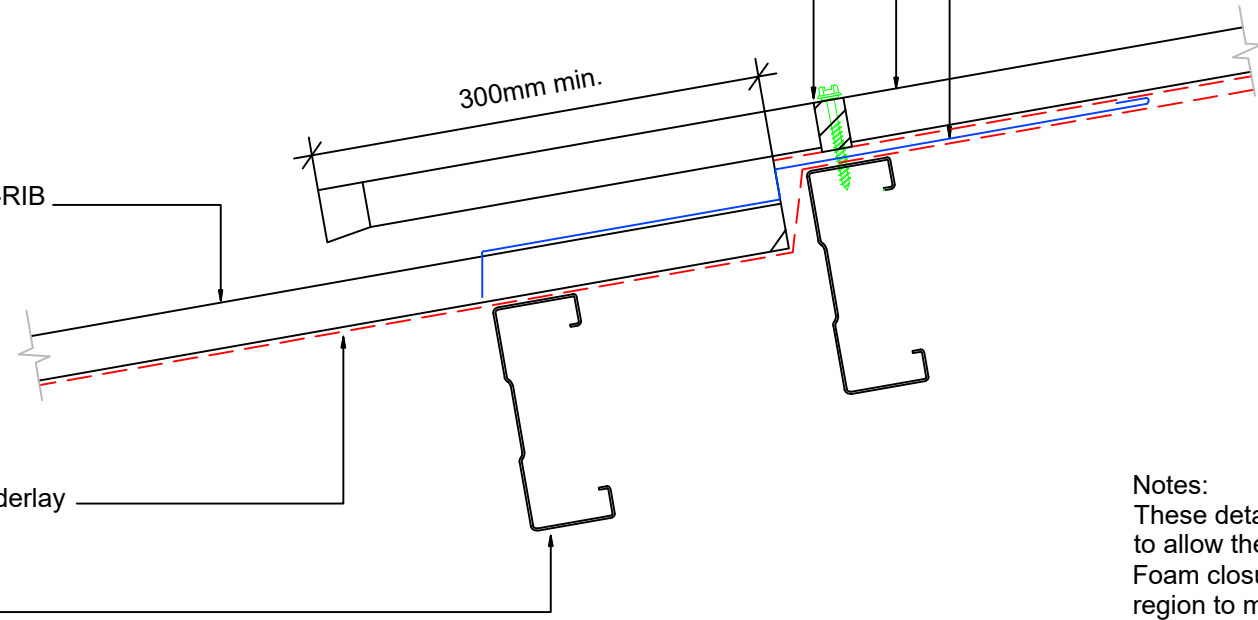

Notes:
 These details are required to be fixed to allow thermal movement .
 Foam closure is required in high wind region to mitigate driving rain migration.
 Foam closure is required to protect from vermin and avian damage.